

Deed, SC, Pendleton, John Millwee, 1815

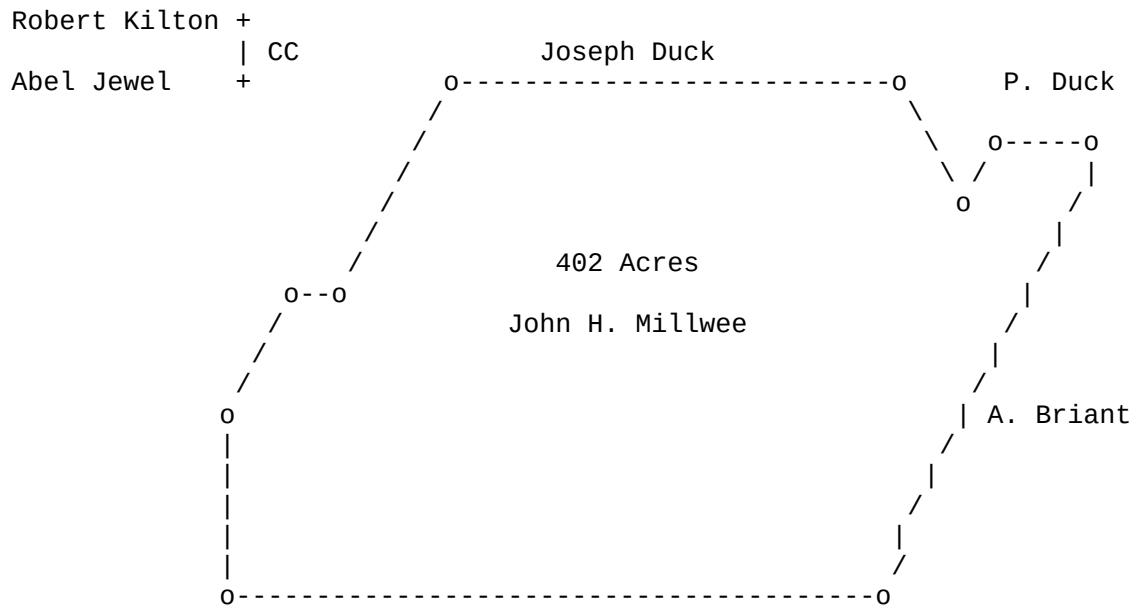

South Carolina

I do certify for **JOHN H. MILLWEE** a plantation or tract of four hundred and two acres of land surveyed for him the 27th of December 1814, situate in Pendleton District on the Little Beaver Dam of Rocky [Rocky] River and hath such form and marks as the above plat represents.

Given under my hand this 13th day of February 1815.

WILLIAM CLARK, Surveyor General

JAMES ANDERSON, Deputy Surveyor

Deed, SC, Pendleton, John Millwee, 1815

```
##### # # ##### ##### # # ##### ##### # #  
# # ## ## # # ## # # # # # # ## ##  
# # # # # # # # # # # # # # # # # # # #  
##### # # # # ##### ##### # # # # # # # #  
# # # # # # # # # # # # # # # # # # # #  
# # # # # # # # # # # # # # # # # # # #  
##### # # ##### ##### # # ### ##### ##### # #
```

Transcribed from original documents by Brent R. Brian & Martha M. Brian.

This document and others can be found on our website:

[BMGEN](#)

We claim **COPYLEFT** on the documents that we publish that are our original work.

COPYLEFT "rules" can be reviewed on the web site:

[GNU Free Documentation License](#)

In short, use what you like. But if you use our stuff, mention us as the source.

Brent R. Brian
Martha M. Brian
BrianMitchellGenealogy@gmail.com