

Deed, SC, Craven, William McKinny, 1767

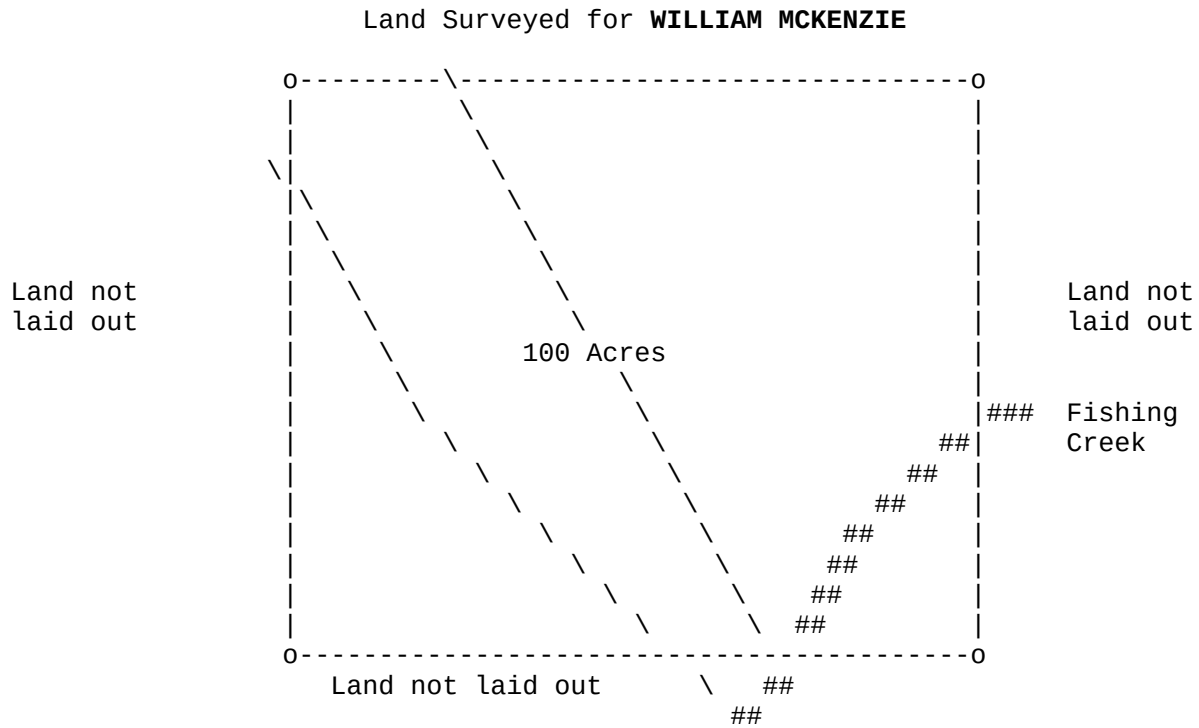

South Carolina

Pursuant to a precept directed to me by **JOHN TROUP**, Esq. D. S. G. dated February 3rd, 1767, I have surveyed and laid out for **WILLIAM MCKINNY** a tract of land containing one hundred acres, situate, lying and being on Fishing Creek, butting and bounding to the NE by land surveyed for **WILLIAM MCKENZIE**, and on all other sides by vacant land, and hath such shapes, forms and marks as the plat above represents.

Certified February 16th, 1767 by

JOHN WINN, D. S.

NB The above mentioned creek is 7 feet wide and 6 inches deep.

Deed, SC, Craven, William McKinny, 1767

```
##### # # ##### ##### # # ##### ##### # #  
# # ## ## # # # ## # # # # # ## ##  
# # # # # # # # # # # # # # # # # # # #  
##### # # # # ##### ##### # # # # # # # #  
# # # # # # # # # # # # # # # # # # # #  
# # # # # # # # # # # # # # # # # # # #  
##### # # ##### ##### # # # # # # # # # #
```

Transcribed from original documents by Brent R. Brian & Martha M. Brian.

This document and others can be found on our website:

[BMGEN](#)

We claim **COPYLEFT** on the documents that we publish that are our original work.

COPYLEFT "rules" can be reviewed on the web site:

[GNU Free Documentation License](#)

In short, use what you like. But if you use our stuff, mention us as the source.

Brent R. Brian
Martha M. Brian
BrianMitchellGenealogy@gmail.com