

Deed, SC, Craven, Hugh Berry 1774

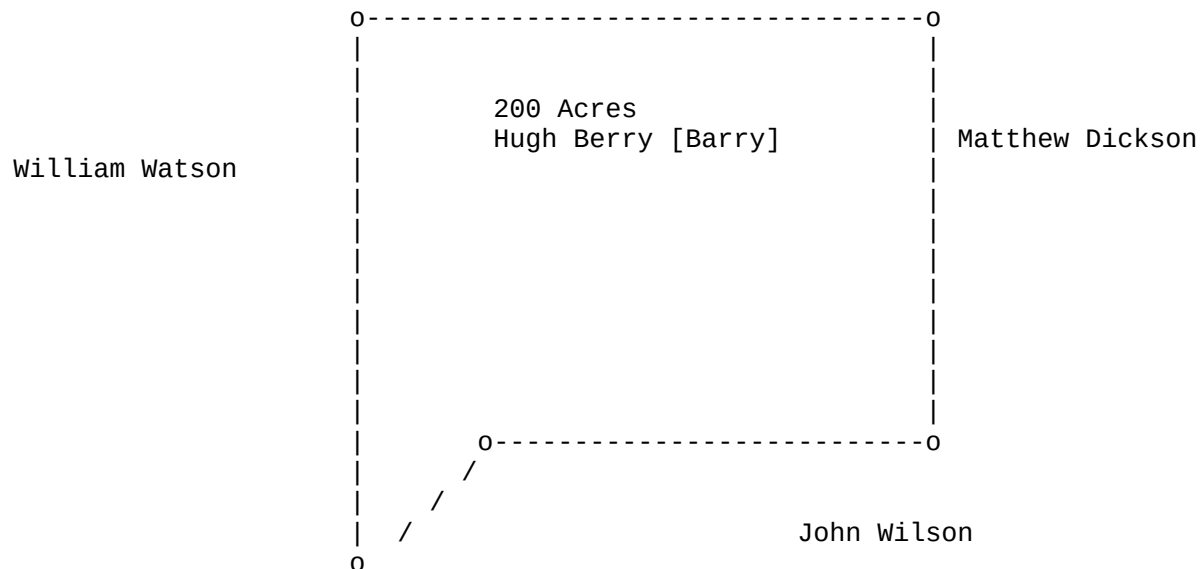

South Carolina  
Camden District

Pursuant to a precept directed by **JOHN BREMAR**, Esq. and Surveyor General dated of the 4<sup>th</sup> of May 1773 I have admeasured and laid out unto HUGH BERRY a tract of land containing two hundred acres in Craven County upon the south side of Fishing Creek. Bounded on the NW by **WILLIAM WATSON'S** land; by **JOHN WILSON'S**; on the SW; and on or nigh **MATTHEW DICKSON'S** on the SE side; and by vacant land on the NE side, having such form an marks as appears by the above delineated plat. Surveyed this 12<sup>th</sup> day of May 1773.

**FRANCIS ADAMS**, Deputy Surveyor

Ord. Co. 8<sup>th</sup> December 1774

**Deed, SC, Craven, Hugh Berry 1774**

PLAT POINTS

=====

N22W 55c

N68E 44.7c

S22E 40c

S57W 27c

S39.34.36W 20.7c

Deed, SC, Craven, Hugh Berry 1774

```
##### # # ##### ##### # # ##### ##### # #  
# # ## ## # # # ## # # # # # # ## ##  
# # # # # # # # # # # # # # # # # # # #  
##### # # # # ##### ##### # # # # # # # #  
# # # # # # # # # # # # # # # # # # # #  
# # # # # # # # # # # # # # # # # # # #  
##### # # ##### ##### # # # # # # # # # #
```

Transcribed from original documents by Brent R. Brian & Martha M. Brian.

This document and others can be found on our website:

[BMGEN](#)

We claim **COPYLEFT** on the documents that we publish that are our original work.

COPYLEFT "rules" can be reviewed on the web site:

[GNU Free Documentation License](#)

In short, use what you like. But if you use our stuff, mention us as the source.

Brent R. Brian  
Martha M. Brian  
[BrianMitchellGenealogy@gmail.com](mailto:BrianMitchellGenealogy@gmail.com)