

Deed, SC, Camden, William Scott R., 1787

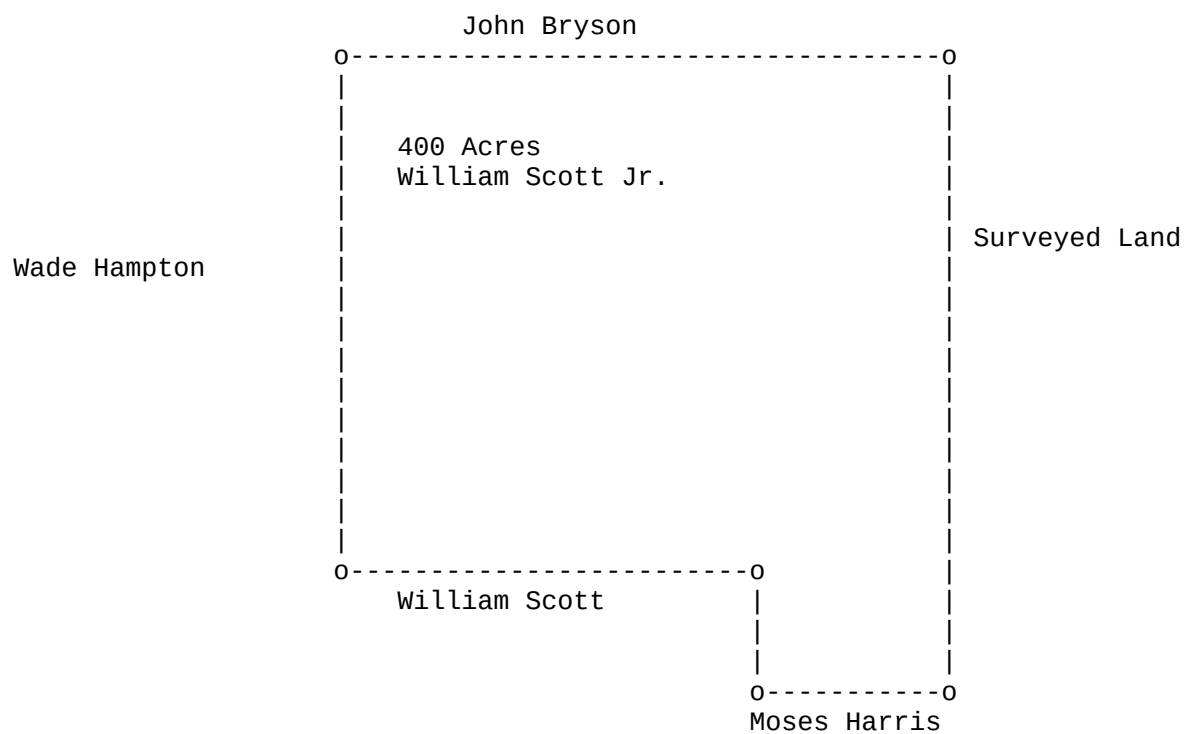

South Carolina

I have caused to be admeasured & laid out unto **WILLIAM SCOTT** Jr. a tract of land containing four hundred acres situate in the district of Camden on Tom's Creek & hath such form, marks, buttings and boundings as the above plat represents.

JOHN BELTON, DS

Certified for the 21st day of August 1787.

EPHRAIM MITCHELL, SG

Deed, SC, Camden, William Scott R., 1787

PLAT POINTS

=====

- N25E 36c
- S64E 25c
- N26E 21.50c
- N64W 81c
- S36W 50c
- S56E 65c

Deed, SC, Camden, William Scott R., 1787

```
##### # # ##### ##### # # ##### ##### # #  
# # ## ## # # # ## # # # # # ## ##  
# # # # # # # # # # # # # # # # # # # # # #  
##### # # # # ##### ##### # # # # # # # #  
# # # # # # # # # # # # # # # # # # # # # #  
# # # # # # # # # # # # # # # # # # # # # #  
##### # # ##### ##### # # # # # # # # # # # #
```

Transcribed from original documents by Brent R. Brian & Martha M. Brian.

This document and others can be found on our website:

[BMGEN](#)

We claim **COPYLEFT** on the documents that we publish that are our original work.

COPYLEFT "rules" can be reviewed on the web site:

[GNU Free Documentation License](#)

In short, use what you like. But if you use our stuff, mention us as the source.

Brent R. Brian
Martha M. Brian
BrianMitchellGenealogy@gmail.com