

Deed, SC, Ninety Six, Robert Wilson, 1784

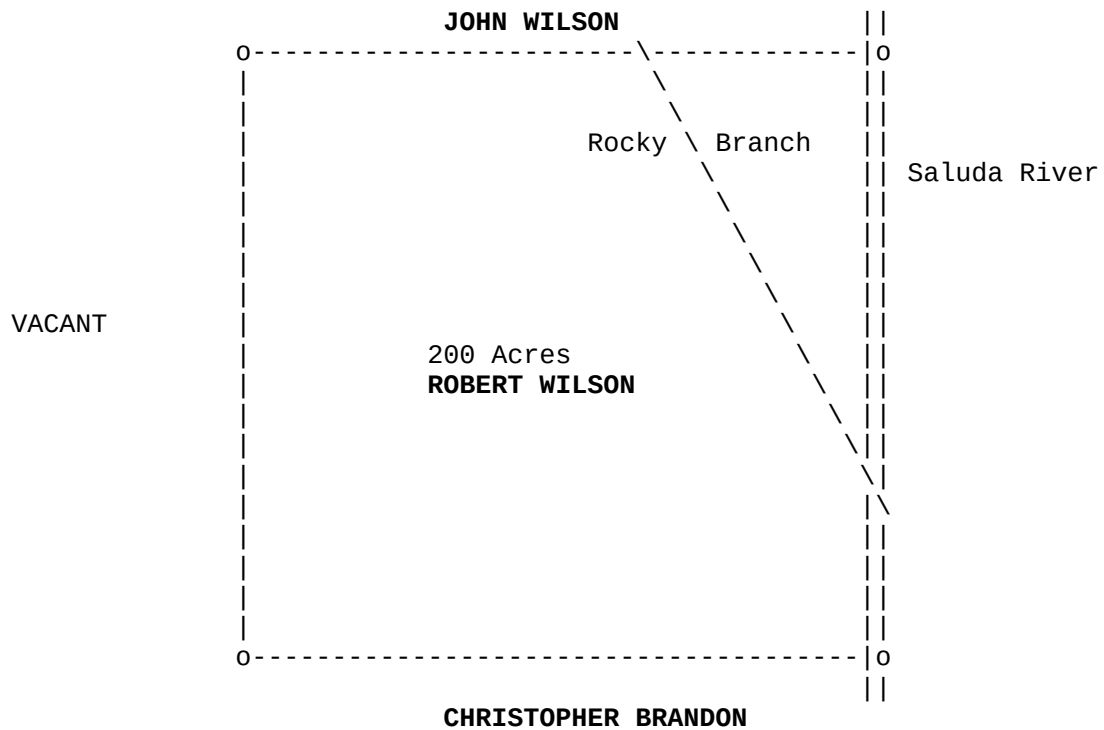

South Carolina

I have cause to be admeasured and laid out unto **ROBERT WILSON** a tract of land containing two hundred acres situate in the District of Ninety Six on the Rocky Branch of Saluda River above the ancient boundary line and hath such form and marks, butting and bounding as the above plat represents.

Certified for the eighteenth day of November, 1784

JONATHAN DOWNS, D. S.

EPHRAIM MITCHELL, Surveyor-General

Deed, SC, Ninety Six, Robert Wilson, 1784

PLAT POINTS

=====

N 44.72c

E 44.72c

S 44.72c

W 44.72c

Deed, SC, Ninety Six, Robert Wilson, 1784

```
##### # # ##### ##### # # ##### ##### # #  
# # ## ## # # # ## # # # # # ## ##  
# # # # # # # # # # # # # # # # # # # # # #  
##### # # # # ##### ##### # # # # # # # #  
# # # # # # # # # # # # # # # # # # # # # #  
# # # # # # # # # # # # # # # # # # # # # #  
##### # # ##### ##### # # # # # # # # # # # #
```

Transcribed from original documents by Brent R. Brian & Martha M. Brian.

This document and others can be found on our website:

[BMGEN](#)

We claim **COPYLEFT** on the documents that we publish that are our original work.

COPYLEFT "rules" can be reviewed on the web site:

[GNU Free Documentation License](#)

In short, use what you like. But if you use our stuff, mention us as the source.

Brent R. Brian
Martha M. Brian
BrianMitchellGenealogy@gmail.com