

Deed, NC, Wake, CHARLES BRUMFIELD, 1785

State of North Carolina

TO ALL TO WHOM these presents shall come, greeting.

KNOW YE, that we, for an inconsideration of the sum of 50 Shillings for every 100 acres hereby granted, paid into our treasury by **CHARLES BRUMFIELD** have given and granted and by these presents to give and grant unto the said **CHARLES BRUMFIELD** attractive land, containing 84 acres, lying and being in our county of Wake.

On the Waters of Beaver Dam

Beginning at a Red Oak, his corner; thence with his line S25E 56 poles to a Red Oak; thence E 188 poles to a Spanish Oak; thence S 80 poles to a Pine in **JAMES MOORE**'s line; thence with said line E 42 poles to a small Hickory, **ISAAC DAWSON**'s corner; thence with his line N 120 poles to a White Oak; thence N67W 50 poles to a Post Oak; thence S75W 156 poles to a Hickory; thence N35W 30 poles to a Water Oak; thence to the first station.

AS BY THE PLAT here unto annexed doth appear, together with all woods, waters, mines, minerals, hereditamins, and appurtinances to the said land belonging or appertaining.

TO HOLD to the said **CHARLES BRUMFIELD** his heirs and assigns forever. yielding and paying to us such sums of money yearly or otherwise as our general assembly from time to time may direct, provided always that the said **CHARLES BRUMFIELD** show cause this grant to be registered in the register's office of our said County of Wake within 12 months from the date hereof otherwise the same shall be void and of no effect.

IN TESTIMONY whereof we have caused our Great Seal to be hereunto affixed.

WITNESS **RICHARD CASWELL**, Esquire, our Governor, Gaptain General, and Commander in Chief at Kingston, the 30th day of September in the year of our Independence and in the year of Our Lord 1788.

J. GLASGOW, secretary

R. CASWELL

Deed, NC, Wake, CHARLES BRUMFIELD, 1785

State of North Carolina

No. 1111

JOHN WHITAKER

ENTRY OFFICER of claims for lands in the county of Wake.

TO THE SURVEYOR of said county, greeting.

YOU ARE HEREBY REQUIRED, as soon as maybe, to lay off and survey for **CHARLES BRUMFIELD** a tract or parcel of land containing 200 Acres, lying at the county aforesaid, joining the lines of **ISAAC DAWSON** and **JAMES MOORE** on the north side of Neuse river.

OBSERVING THE DIRECTIONS of the Act of Assembly in such case made and provided for running out lands, two just and fair plans of such survey, with a proper certificate annexed to each, you are to transmit, with this warrant, to the secretary's office, without delay.

Given under my hand at Steephill 27th day of September Anno Domini 1779.

JOHN WHITAKER

Deed, NC, Wake, CHARLES BRUMFIELD, 1785

No. 825

County: Wake

Name: **BRUMFIELD, CHARLES**

Acres: 84

Grant No. 885

Issued: September 30, 1785

Warrant No. Entry No. 1111

Entered: September 27, 1779

Book No. 60 Page No. 132

Location: On the waters of Beaver Dam

Deed, NC, Wake, CHARLES BRUMFIELD, 1785

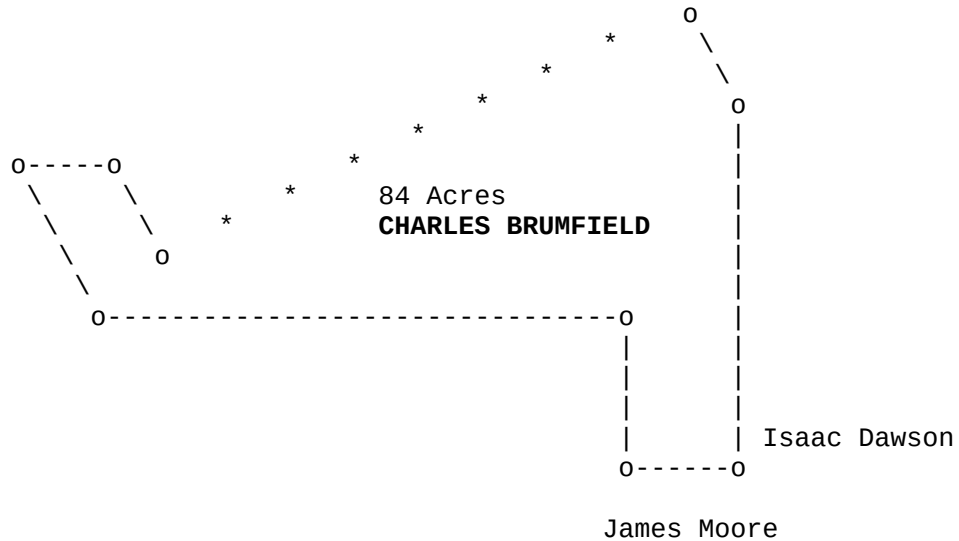

Plotted by a scale of 100 poles in an inch

Surveyed May 25th 1782 for **CHARLES BRUMFIELD** a tract of land containing 84 Acres lying in Wake County on the waters of Beaver Dam.

Beginning at a Red Oak, his corner; thence with his line S25E 56 poles to a Red Oak; thence E 188 poles to a Spanish Oak; thence S 80 poles to a Pine in **JAMES MOORE**'s line; thence with said line E 42 poles to a small Hickory, **ISAAC DAWSON**'s corner; thence with his line N 120 poles to a White Oak; thence N67W 50 poles to a Post Oak; thence S75W 156 poles to a Hickory; thence N35W 30 poles to a Water Oak; thence to the first station.

JOHN HUMPHRIES, surveyor

Chain Bearers
JOHN BRUMFIELD
WILLIAM REVES

Deed, NC, Wake, CHARLES BRUMFIELD, 1785

PLOT POINTS

=====

S25E 56p

E 188p

S 80p

E 42p

N 120p

N67W 50p

S75W 160p

N35W 30p

N77W 37p

Deed, NC, Wake, CHARLES BRUMFIELD, 1785

```
##### # # ##### ##### # # ##### ##### # #  
# # ## ## # # # ## # # # # # ## ##  
# # # # # # # # # # # # # # # # # # #  
##### # # # # ##### ##### # # # # # # # #  
# # # # # # # # # # # # # # # # # # #  
# # # # # # # # # # # ## ### # # # # # # #  
##### # # ##### ##### # # ### ##### ##### # #
```

Transcribed from original documents by Brent R. Brian & Martha M. Brian.

This document and others can be found on our website:

[BMGEN](#)

We claim **COPYLEFT** on the documents that we publish that are our original work.

COPYLEFT "rules" can be reviewed on the web site:

[GNU Free Documentation License](#)

In short, use what you like. But if you use our stuff, mention us as the source.

Brent R. Brian
Martha M. Brian
BrianMitchellGenealogy@gmail.com